

PREPARED FOR
JOE SCHULTZ
REMAX GENEVA REALTY
101 BROAD ST.
SUITE 101
LAKE GENEVA WI. 53147

PLAT OF SURVEY
-OF-

KROTT SURVEYING INC.

N3705 WILLOW BEND LANE
LAKE GENEVA WI. 53147
PHONE # (262)248-3697
FAX # (262)249-0639

OUTLOTS 205 AND 206 OF THE ASSESSOR'S PLAT OF THE VILLAGE OF WALWORTH, WALWORTH COUNTY, WISCONSIN. ALSO DESCRIBED AS FOLLOWS, TO-WIT: BEGINING AT A POINT 7 CHAINS AND 77 1/2 LINKS EAST OF THE NORTHWEST CORNER OF THE SOUTHWEST 1/4 OF SECTION 22, TOWNSHIP 1 NORTH, RANGE 16 EAST; RUNNING EAST 1 CHAIN; THENCE SOUTH 3 CHAINS AND 33 1/3 LINKS; THENCE WEST 1 CHAIN; THENCE NORTH 3 CHAINS 33 1/3 LINKS TO THE PLACE OF BEGINNING. ALSO COMMENCING 8 CHAINS AND 77 1/2 LINKS EAST OF THE NORTHWEST CORNER OF THE SOUTHWEST 1/4 OF SECTION 22, TOWNSHIP 1 NORTH, RANGE 16 EAST; RUNNING EAST 1 CHAIN; THENCE SOUTH 3 CHAINS AND 33 1/3 LINKS; THENCE WEST 1 CHAIN; THENCE NORTH 3 CHAINS 33 1/3 LINKS TO THE PLACE OF BEGINNING

NORTHWEST CORNER OF THE
SOUTHWEST 1/4 SEC. 22-1-17

NORTHEAST CORNER OF THE
SOUTHWEST 1/4 SEC. 22-1-17

C.L. KENOSHA STREET AKA STATE HIGHWAY "67"

N 90°00'00" E

(EAST 132')

132.05'

2017.51'

OUTLOT 205

OUTLOT 206

GRAVEL IS 1.1'
EAST OF LOT LINE

GRAVEL IS 4.0'
EAST OF LOT LINE

GRAVEL IS 7.9'
EAST OF LOT LINE

EXISTING HOUSE

DECK

ASPHALT DRIVE

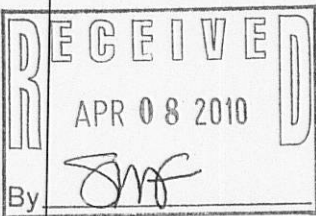

LEGEND

- FOUND IRON PIPE
- ⊕ FOUND CONCRETE MONUMENT
- FOUND COUNTY MONUMENT
- ⊗ UTILITY POLE
- OVERHEAD WIRES

(XX) RECORDED AS
TAX ID # VWP00270 & 271
JOB # 10-059

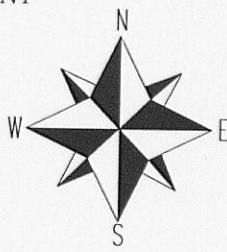

NOTE: BEARINGS ARE ASSUMED AND THE NORTH LINE OF THE
SOUTHWEST 1/4 OF SEC. 22-1-16 WAS ASSUMED TO BEAR N 90°00'00" E

SCALE 1" = 20'

I have surveyed the above-described property and the above map is a true representation thereof and shows the size and location of the property, its exterior boundaries, the location and dimensions of all structures thereon, fences apparent easements and roadways and visible encroachments, if any.

This survey is made for the exclusive use of the present owners of the property, and also those who purchase, mortgage, or insure the title thereto within one (1) year from date hereof; and as to them I warrant the accuracy of said survey map.

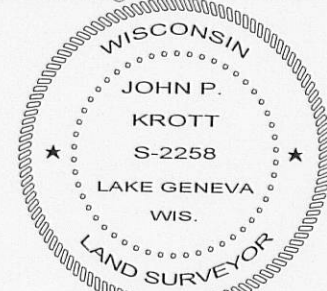

DATED THIS 2nd DAY OF APRIL 2010.

John P. Krott

JOHN KROTT S - 2258
Wisconsin Registered Land Surveyor
(original if signed in red)